

## Ground tap connectors



**Figure 6 compression ground tap connectors**

- Material: High-conductivity copper
- Acceptable for direct burial



Cat. no.	Application (AWG or kcmil)		Cable to rebar application*		Dimensions in. (mm)		Dies for TBM14M, 13100A or TBM15I	Number of crimps
	Main	Tap	Main	Tap (AWG or kcmil)	T	H		
54855	1/0 str.–250	#4 sol.–#2 str.	#3 Rebar 3/8 thru	#4 sol.–#2 str.	0.75 (19.1)	1.94 (49.3)	15G86R	1
54860	or 1/2 in.–5/8 in. rod	1/0 str.–2/0 str.	1/2 in. #4 rebar	1/0 str.–2/0 str.	0.75 (19.1)	2.19 (55.6)	15G86R	1
54865-CK		3/0 str.–250		3/0 str.–250	0.75 (19.1)	2.19 (55.6)	15G86R	1
54875	#6 sol.–#2 str.	#6 sol.–#2 str.	–	–	0.75 (19.1)	2.56 (65.0)	15501A	1
54885	250–500 or 3/4 in.–3/4 in. rod	#4 sol.–#2 str.	–	–	0.75 (19.1)	1.94 (49.3)	15G126R	1
54890	250–500 or 3/4 in.–3/4 in. rod	1/0 str.–2/0 str.	#5 Rebar 5/8 thru	1/0 str.–2/0 str.	0.75 (19.1)	2.13 (54.1)	15G126R	1
54895		3/0 str.–250	3/4 in. #6 rebar	3/0 str.–250	0.75 (19.1)	2.19 (55.6)	15G126R	1
54900		350–500		350–500	1.38 (35.1)	2.44 (62.0)	15G121R	3

**Diagrams**

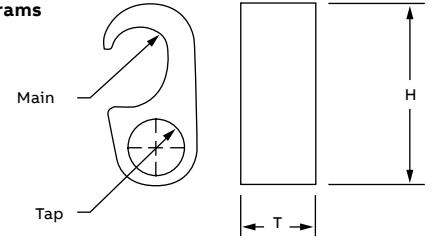

\* CSA not applicable.  
 Tin-plated version of galvanized ground rods available. Add suffix -TP to cat. no.  
 Use 15500TB adaptor for TBM15I 15-ton tool.



Cat. no.	Application		Dies for ABB tools (Figure 2)	L (in.)
	Main	Tap (AWG or kcmil)		
54865-CKN*	3/4 in. rod	3/0 str.–250	15506SS	1 1/2
54860N	3/4 in. rod	1/0 str.–2/0 str.	15506SS	1 1/2
54855N	3/4 in. rod	#4 sol.–#2 str.	15506SS	1 1/2
54875N	#6 sol.–#2 str.	#6 sol.–#2 str.	15517SS	1 1/2

**Diagrams**

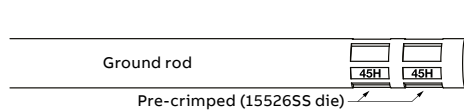

Figure 1

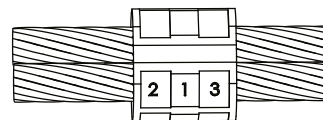
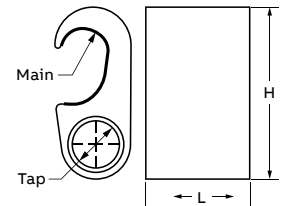

Figure 2 – Requires 3 crimps



All parts ending by the letter N are IEEE837-2014 compliant.  
 Use hydraulic tool 13100A, TBM14M TBM14CR-LI, TBM15CR-LI, TBM15, or TBM15I with die indicated in chart.  
 Use 15500TB adaptor for TBM15I 15-ton tool.

**IMPORTANT:** For 54865-CKN only. To be in compliance with IEEE837-2014, the ground rod should be pre-crimped with die 15526SS (45H) as shown in Figure 1.

## Ground rod tap connectors



**Figure 8 compression ground rod tap connectors**

- Material: High-conductivity copper
- Acceptable for direct burial



Cat. no.	A (in.) Ground rod	B Cable range (AWG or kcmil)	Dimensions in. (mm)		Dies for TBM14M 13100A or TBM15I	Number of crimps
			T	H		
GR12-202*	½	#2-2/0	0.88 (22.4)	1.94 (49.3)	15G121R	2
GR58-202*	⅝	#2-2/0	0.88 (22.4)	1.97 (50.0)	15G121R	2
GR34-202*	¾	#2-2/0	0.88 (22.4)	2.19 (55.6)	15G121R	2
GR1-202	1	#2-2/0	0.88 (22.4)	2.56 (65.0)	15G121R	2
GR12-40250*	½	4/0-250	0.88 (22.4)	1.94 (49.3)	15G121R	2
GR58-40250*	⅝	4/0-250	0.88 (22.4)	2.13 (54.1)	15G121R	2
GR34-40250*	¾	4/0-250	0.88 (22.4)	2.19 (55.6)	15G121R	2
GR1-40250	1	4/0-250	0.88 (22.4)	2.44 (62.0)	15G121R	2
GR58-300500*	⅝	300-500	0.88 (22.4)	2.13 (54.1)	15G121R	2
GR34-300500*	¾	300-500	0.88 (22.4)	2.44 (62.0)	15G121R	2
GR1-300500	1	300-500	0.88 (22.4)	2.69 (68.3)	15G121R	2

**Diagrams**

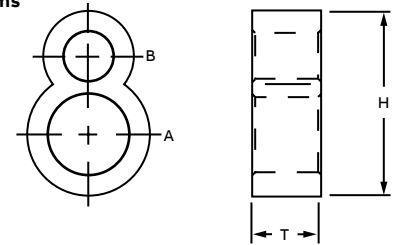

\*Tin-plated version of galvanized ground rods available. Add suffix -TP to cat. no.  
Use 15500TB adaptor for TBM15I 15-ton tool.  
Optional ground rod knurling die for 14- and 15-ton tools: 15508. Knurling tool: 240-31565-94.

## Ground rod to grid connectors

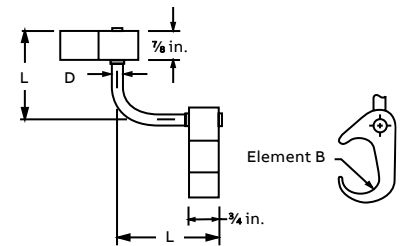

Figure 6 to 8 compression ground rod to grid connectors

DB    Meets IEEE 837 requirements

Cat. no.	A in. (mm) Ground rod	B Cable range (AWG or kcmil)	Dimensions in. (mm)		Dies for TBM14M, 13100A or TBM15I	
			D	L	Element A	Element B
54855LR12*	½ (12.7)	#2-250	0.31 (7.8)	2.50 (63.5)	15G121R	15G86R
54885LR12*	½ (12.7)	250-500	0.31 (7.8)	2.50 (63.5)	15G121R	15G126R
54865LR58*	¾ (16.0)	#2-250	0.31 (7.8)	2.50 (63.5)	15G121R	15G86R
54895LR58*	¾ (16.0)	250-500	0.31 (7.8)	2.50 (63.5)	15G121R	15G126R
54875LR34*	¾ (19.1)	#2-250	0.50 (12.7)	2.63 (66.8)	15G121R	15G86R
54900LR34*	¾ (19.1)	250-500	0.50 (12.7)	2.63 (66.8)	15G121R	15G126R
54910LR100	1 (25.4)	#2-250	0.50 (12.7)	2.63 (66.8)	15G121R	15G86R
54920LR100	1 (25.4)	250-500	0.50 (12.7)	2.63 (66.8)	15G121R	15G126R

Diagrams



\*Tin-plated version available for galvanized ground rods. Add suffix -TP to cat. no.

## Ground grid connectors

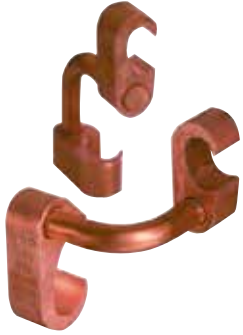

**Figure 6 to 6 compression ground grid connectors**

- Material: High-conductivity copper
- Acceptable for direct burial



Cat. no.	A Cable range (AWG or kcmil)	B to cable range (AWG or kcmil)	B to ground rod	B to rebar	D (in.)	T (in.)	Dies for ABB tool*			
							Number A of crimps	Number B of crimps	Number A of crimps	Number B of crimps
54900L	250-500	250-500	5/8 in.-3/4 in. rod	#5-#6 (5/8 in.-3/4 in.)	3/4	1 1/8	15G121R	3	15G121R	3
54895L	#2 str.-250	250-500	5/8 in.-3/4 in. rod	#5-#6 (5/8 in.-3/4 in.)	1/2	3/4	15G86R	1	15G126R	1
54885L	#6 sol.-#2 str.	250-500	5/8 in.-3/4 in. rod	#5-#6 (5/8 in.-3/4 in.)	5/8	3/4	15501A	1	15G126R	1
54875L	#2 str.-250	#2 str.-250	1/2 in.-5/8 in. rod	#3-#4 (3/8 in.-1/2 in.)	1/2	3/4	15G86R	1	15G86R	1
54865L	#6 sol.-#2 str.	#1 str.-250	1/2 in.-5/8 in. rod	#3-#4 (3/8 in.-1/2 in.)	5/16	3/4	15501A	1	15G86R	1
54855L	#6 sol.-#2 str.	#6 sol.-#2 str.	-	-	5/16	3/4	15501A	1	15501A	1

**Diagrams**

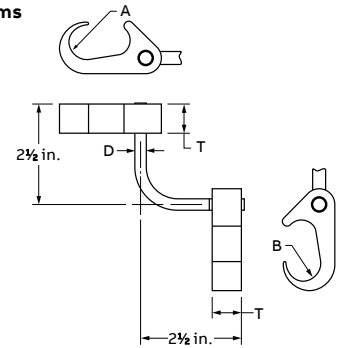

\*Use hydraulic tool 13100A, TBM14CR-LI, TBM14M, TBM15CR-LI, TBM15, or TBM15I or with die marked on cat. no. Use 15500TB adaptor for 15-ton tool TBM15I.

## Cable-to-cable or cable-to-rod connectors

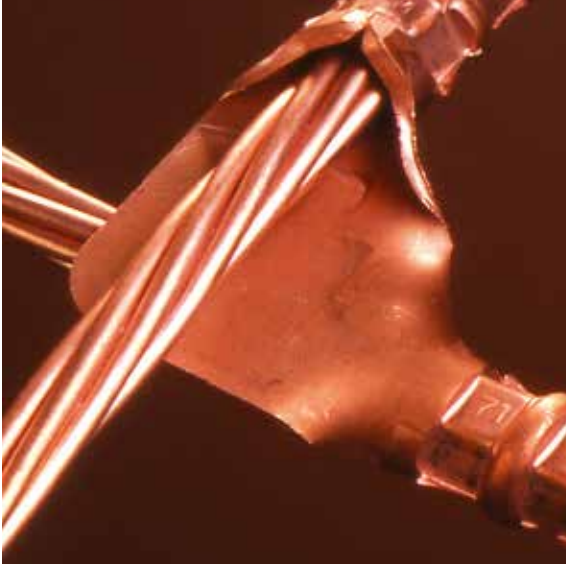

### One-piece construction for cable-to-cable, cable-to-rod, "T" and "X" connections

- Suitable for direct burial or in concrete
- Replaces exothermic welds
- Made from high-conductivity wrought copper



Cat. no.	Cable to cable range							Rod to cable range						
	Main (AWG or kcmil)	Die code	TBM14 and 15 Die cat. no.	Number of crimps	Branch (AWG or kcmil)	Die code	TBM14 and 15 Die cat. no.	Number of crimps	Ground rod (in.)	Die code	TBM14 and 15 Die cat. no.	Cable (AWG or kcmil)	Die code	TBM14 and 15 Die cat. no.
GG21-21	#2 or #1	45	15526SS	2	#2 or #1	45	15526SS	2	-	-	-	-	-	-
GG10-10	1/0	54	15511SS	2	1/0	54	15511SS	2	-	-	-	-	-	-
GG2030-21	2/0 or 3/0	60	15532SS	2	#2 or #1	50-45	15526SS 15530SS	2	-	-	-	-	-	-
GG2030-10	2/0 or 3/0	60	15532SS	2	1/0	54H	15511SS	2	-	-	-	-	-	-
GG2030-2030	2/0 or 3/0	60	15532SS	2	2/0-3/0	60	15532SS	2	-	-	-	-	-	-
GG40250-21	4/0 or 250	71H	15514SS		#2	45	15526SS 50 15530SS	2	1/2 5/8	71 80H	15514SS 15517SS	#2 or #1 #2 or #1	45 50	15526SS 15530SS
GG40250-10	4/0 or 250	71H	15514SS		1/0	54H	15511SS	2	1/2 5/8	71 80H	15514SS 15517SS	1/0	54	15511SS
GG40250-2030	4/0 or 250	71H	15514SS		2/0 or 3/0	60	15532SS	2	1/2 5/8	71 80H	15514SS 15517SS	2/0 or 3/0 2/0 or 3/0	60 60	15532SS 15532SS
GG40250-40250	4/0 or 250	71H	15514SS		4/0 or 250	71H	15514SS	2	1/2 5/8	71 80H	15514SS 15517SS	4/0 or 250 4/0 or 250 4/0 or 250	71H 71H 71H	15514SS 15514SS 15514SS
GG500-40250	500	87H	15506SS		4/0 or 250	71H	15514SS	2	3/4 5/8	87H	15506SS	4/0 or 250 4/0 or 250 4/0 or 250	71H 71H 71H	15514SS 15514SS 15514SS
GG500-500	500	87H	15506SS		500	87H	15506SS	2	3/4 5/8	87H	15506SS	500	87H	15506SS
GG500-350	500	87H	15506SS		350	80H	15606SS	2	3/4 5/8	87H	15506SS	350	80H	15506SS
GG500-2030	500	87H	15506SS		2/0 or 3/0	60	15532SS	2	3/4 5/8	87H	-	2/0 or 3/0	60	15532SS
GG350-350	350	80H	15506SS		350	80H	15606SS	2	-	-	-	-	-	-

Uses 15500TB adaptor for 15-ton tools.

Optional ground rod knurling die or TBM14 and 15 tools: 15508SS.

Optional ground rod knurling tool: 240-31565-94.

## Two cables to ground rod



For connecting perpendicular runs of stranded copper cable to ground rod



Cable and rod installing dies for TBM14 and 15

Cat. no.	Cable size (AWG or kcmil)		Ground rod dia. (in.)	Die code	Ground cable		Ground rod		Overall dimensions in. (mm)		
	Main	Tap			Cat. no.	Number of crimps	Die code	Cat. no.	Number of crimps	L1	L2
53065-58GR	250 or 4/0	250 or 4/0	5/8 and 1/2	87H	15506SS	2	87H	15506SS	2	4.94 (125.5)	3.25 (82.6)
53065-34GR	250 or 4/0	250 or 4/0	3/4	87H	15515SS	2	106H	15515SS	2	4.94 (125.5)	3.25 (82.6)

Diagram

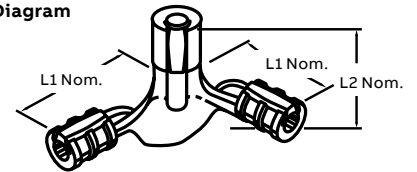

Use T&B hydraulic tools with hex crimp dies.

Optional ground rod knurling die for TBM14 and 15 Tools: 15508SS.

Optional ground rod knurling Tool: 240-31565-94.

Use 15500TB adaptor for TBM15-Ton Tool.

Cable size (AWG or kcmil)	Reinforcing rod size	Copperweld* conductor size
#2, #1	—	3 #8 or 3 #6
1/0, 2/0	#3	3/8 (7 #8) or 1/16 (7 #7)
4/0, 250	#4	7/16 (19 #9) or (7 #5)
300-350	#5	2 1/32 (19 #8) or 5/8 (7 #4)
500	#6	1 3/16 (19 #6)

\* Reg. Trademark Copperweld Corporation.

UL listed for use with cast copper connectors.

## Grounding grid connectors



53065



53055

### Heavy-duty cast copper\*\*



Cat. no.	Rod to cable range		Cable to cable range rod (AWG or kcmil)		Cable and rod installing dies for TBM14 and 15					Overall dimensions in. (mm)		
	Rod size (in.)	Cable range (AWG or kcmil)	Main	Branch	Die code	Cat. no.	Number of crimps	Die code	Cat. no.	Number of crimps	L1	L2
53055	-	-	1/0-2/0	1/0-2/0	-	-	-	66	15534SS	1	3.88 (98.6)	3.88 (98.6)
53059*	½-¾	#2-#1	4/0-250	#2-#1	87H	15506SS	2	54H	15511SS	2	4.16 (105.7)	4.56 (115.8)
53060*	½-¾	1/0-2/0	4/0-250	1/0-2/0	87H	15506SS	2	87H	15506SS	2	4.44 (112.8)	4.44 (112.8)
53065*	½-¾	4/0-250	4/0-250	4/0-250	87H	15506SS	2	87H				
53069*	¾	1/0-2/0	300-350	1/0-2/0	106H	15515SS	2	66	15534SS	1	4.59 (116.6)	4.59 (116.6)
53071*	¾	4/0-250	300-350	4/0-250	106H	15515SS	2	106H	15515SS	2	5.25 (133.4)	4.78 (121.4)
53073*	1	1/0-2/0	500	1/0-2/0	125H	15603	3	66	15534SS	1	4.81 (122.2)	4.88 (124.0)
53075*	1	4/0-250	500	4/0-250	125H	15603	3	87H	15506SS	2	6.56 (166.6)	5.00 (127.0)
53080*	1	500	500	500	125H	15603	3	125H	15603	3	5.19 (131.8)	5.19 (131.8)

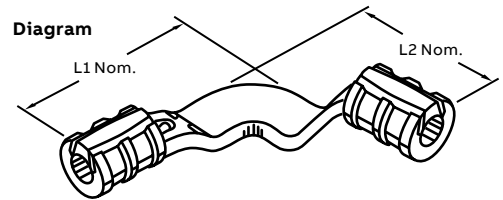

\* 4/0-250 wire barrels suitable for ½ in. and ¾ in. rod, 300-500 kcmil wire barrels suitable for ¾ in. rods, 500 kcmil wire barrels suitable for 1 in. rods.

\*\* Do not meet IEEE837.

Cat. no. 15500TB adaptor is required for all 15500SS series dies, not for 15600SS series, crimp with 15-ton tools.

Hydraulic tools only.

## C-Taps



DB    Meets IEEE 837 requirements

Cat. no.	Cable range (AWG or kcmil)		Dimensions in. (mm)		Dies for TBM14M, 13100A or TBM15I*	Crimps
	Main	Tap	H	L		
CTP22	#6 sol.-#2 str.	#6 sol.-#2 str.**	1.16 (29.5)	0.75 (19.1)	HBKC	1
CTP202	#1 str.-2/0 str.	#6 sol.-#2 str.**	1.41 (35.8)	0.75 (19.1)	15501A	1
CTP2020	#1 str.-2/0 str.	#1 str.-2/0 str.	1.54 (39.1)	0.75 (19.1)	15501A	1
CTP25020	3/0 str.-250	#6 sol.-2/0**	1.97 (50.0)	0.75 (19.1)	15G86R	1
CTP250250	3/0 str.-250	3/0 str.-250	2.06 (52.3)	0.88 (22.4)	15G86R	1
CTP50020	300-500	#6 sol.-2/0**	2.42 (61.5)	0.88 (22.4)	15G121R	2
CTP500250	300-500	3/0 str.-250	2.67 (67.8)	0.88 (22.4)	15G121R	2
CTP500500†	300-500	300-500	2.91 (73.9)	1.10 (27.9)	15G121R	3

Diagrams

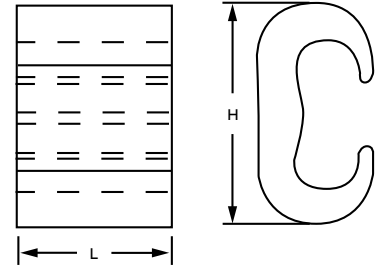

\* Cat. no. 15500 adaptor required if using TBM15I and 155XX series dies.

\*\* #6 AWG branch must be doubled.

† Must use TBM15I tool

Material: High-conductivity copper.

# C-Taps



DB c Meets IEEE 837-2014 requirements

Cat. no.	Ø A cable (AWG or kcmil)	Ø B cable (AWG or kcmil)	H (in.)	L (in.)	Crimps	Dies for tools*
CTP22N	#6 sol.-#2 str.	#6 sol.-#2 str.	1 <sup>3</sup> / <sub>32</sub>	1 <sup>1</sup> / <sub>2</sub>	3	15534SS (Fig.1)
CTP202N	#1 str.-2/0 str.	#6 sol.-#2 str.	1 <sup>19</sup> / <sub>32</sub>	1 <sup>1</sup> / <sub>2</sub>	3	15517SS (Fig.1)
CTP2020N	#1 str.-2/0 str.	#1 str.-2/0 str.	1 <sup>9</sup> / <sub>16</sub>	1 <sup>1</sup> / <sub>2</sub>	3	15517SS (Fig.1)
CTP25020N	3/0 str.-250	#1 str.-2/0 str.	1 <sup>31</sup> / <sub>32</sub>	1 <sup>1</sup> / <sub>2</sub>	3	15506SS (Fig.1)
CTP250250N†	3/0 str.-250	3/0 str.-250	2 <sup>1</sup> / <sub>16</sub>	1 <sup>1</sup> / <sub>2</sub>	3	15506SS (Fig.1)
CTP500250N	300-500	3/0 str.-250	2.72	2.5	5	15603SS
CTP50020N	300-500	#6 sol.-2/0 str.	2.42	2.5	5	15603SS
CTP500500N**	300-500	300-500	2.92	2.5	5	15G121N

Diagrams

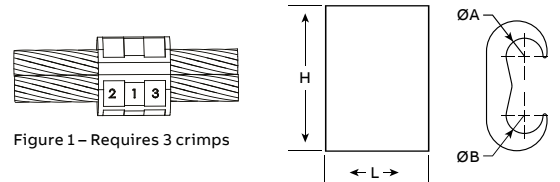

\* These dies may be used with the TBM15CR-LI or TBM15I compression tools. Please note that the die adapter 15500-TB is required for use with these tools.  
 \*\*Can be used with 3/4 in. (17.3 mm) copper-clad ground rod. The ground rod must be pre-crimped with die 15507SS to comply with IEEE 837-2014.  
 † Can be used with 5/8 in. (15.8 mm) copper-clad ground rod. The ground rod must be pre-crimped with die 15526SS to comply with IEEE 837-2014.



Copper C-crimps wire combinations\*\*

Cat. no.	Cable range (AWG)		Die index	Manual tool OD series	Installing die 14- and 15-ton tools	Dimensions in. (mm)	
	Run	Tap				L	H
BC48	6 sol.-4 str.	8 sol.-8 str.	BG or 5/8	BY31	B58CS	0.64 (16.3)	0.56 (14.2)
BC46-BB	6 sol.-4 str.	6 sol.-6 str.	BG or 5/8	BY31	B58CS	0.64 (16.3)	0.75 (19.1)
BC44	6 sol.-4 str.	4 sol.-4 str.	BG or 5/8	BY31	B58CS	0.64 (16.3)	0.80 (20.3)
BC24	2 sol.-2 str.	8 sol.-4 str.	C	BY33	HBKC	0.75 (19.1)	0.98 (24.9)
BC22	2 sol.-2 str.	2 sol.-2 str.	C	BY33	HBKC	0.75 (19.1)	1.05 (26.7)
BC202	1/0 sol.-2/0 str.	8 sol.-2 str.	E or O	-	HO	0.94 (23.9)	1.31 (33.3)
BC2020-BB	1/0 sol.-2/0 str.	1/0 str.-2/0 str.	E or O	-	HO	0.94 (23.9)	1.34 (34.0)
BC402	3/0 str.-4/0 str.	6 sol.-2 str.	F or D3	-	HD	1.06 (26.9)	1.63 (41.4)
BC4020	3/0 str.-4/0 str.	1/0 sol.-2/0 str.	F or D3	-	HD	1.06 (26.9)	1.63 (41.4)
BC4040	3/0 str.-4/0 str.	3/0 sol.-4/0 str.	F or D3	-	HD	1.06 (26.9)	1.63 (41.4)

Diagrams

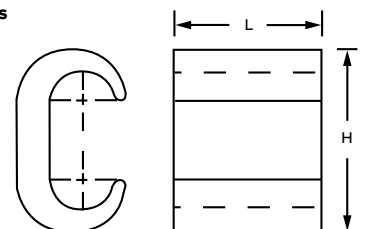

\*\*Do not meet IEEE 837.

## C-Taps



Small size



Cat. no.	Code wire comb. (AWG)		Die		Smart™ Tools		Insulation choice		Dimensions in. (mm)		Colour code	
	Main	Branch	Group 1	TBM62PCR-LI	Group 2	Group 3	Adhesive	Shrink tubing	L	H		
54705	#12	#14	6TON21SS	TBM6221	–	•	•	AC5X3	HS12-6	0.31 (7.9)	0.31 (7.9)	Red
	#14	#16	6TON21SS	TBM6221	–	•	•	AC5X3	HS12-6	0.31 (7.9)	0.31 (7.9)	
54710	#10	#10	6TON24SS	TBM6224	–	•	•	AC5X3	HS12-6	0.56 (14,2)	0.44 (11.2)	Blue
	#8	#12	6TON24SS	TBM6224	–	•	•	AC5X3	HS12-6	0.56 (14,2)	0.44 (11.2)	
54715	#6	#10, 12	6TON29SS	TBM6229	–	•	•	AC5X3	HS12-6	0.56 (14,2)	0.63 (16.0)	Grey
	#8	#8, 10, 12	6TON29SS	TBM6229	–	•	•	AC5X3	HS12-6	0.56 (14,2)	0.63 (16.0)	
54720	#4 ou 5		6TON33SS	TBM6233	TBM8-750C20	•	•	AC5X3	HS6-1	1.16 (29.5)	0.69 (17.5)	Brown
	#6	#6, 8	6TON33SS	TBM6233	TBM8-750C20	•	•	AC5X3	HS6-1	1.16 (29.5)	0.69 (17.5)	
54725	#3	#6, 8, 10, 12***	6TON37SS	TBM6237	TBM8-750C2530	•	•	AC5X3	HS6-1	1.16 (29.5)	0.81 (20.6)	Green
	#4 ou 5	#6, 5	6TON37SS	TBM6237	TBM8-750C2530	•	•	AC5X3	HS6-1	1.16 (29.5)	0.81 (20.6)	
54730	#2	#6, 8, 10, 12	6TON42SS	TBM6242	TBM8-750C2530	•	•	AC5X3	HS6-1	1.16 (29.5)	0.84 (21.3)	Pink
	#3	#5	6TON42SS	TBM6242	TBM8-750C2530	•	•	AC5X3	HS6-1	1.16 (29.5)	0.84 (21.3)	
	#4	#3	6TON42SS	TBM6242	TBM8-750C2530	•	•	AC5X3	HS6-1	1.16 (29.5)	0.84 (21.3)	
54735	#1	#4, 5, 6, 8, 10, 12	6TON45SS	TBM6245	TBM8-750C3540	•	•	AC5X3	HS6-1	0.06 (1.5)	0.88 (22.4)	Black
	#2	#4, 5	6TON45SS	TBM6245	TBM8-750C3540	•	•	AC5X3	HS4-30	0.06 (1.5)	0.88 (22.4)	
	#3	#3, 4	6TON45SS	TBM6245	TBM8-750C3540	•	•	AC5X3	HS4-30	0.06 (1.5)	0.88 (22.4)	
54740	1/0	#4, 5, 6, 8, 10, 12	6TON50SS	TBM6250	TBM8-750C3540	•	•	AC5X3	HS4-30	1.69 (42,9)	0.97 (24.6)	Orange
	#1	#3, 4	6TON50SS	TBM6250	TBM8-750C3540	•	•	AC5X3	HS4-30	1.69 (42,9)	0.97 (24.6)	
	#2	#2, 3	6TON50SS	TBM6250	TBM8-750C3540	•	•	AC5X3	HS4-30	1.69 (42,9)	0.97 (24.6)	
54745	2/0	#3, 4, 5, 6, 8, 10, 12	6TON54SS	TBM6254	TBM8-750C4550	•	•	AC5X3	HS4-30	1.69 (42,9)	1.06 (26.9)	Purple
	1/0	#2, 3	6TON54SS	TBM6254	TBM8-750C4550	•	•	AC5X3	HS4-30	1.69 (42,9)	1.06 (26.9)	
	#1	#1, 3	6TON54SS	TBM6254	TBM8-750C4550	•	•	AC5X3	HS4-30	1.69 (42,9)	1.06 (26.9)	
54750	3/0	#2, 3, 4, 5, 6, 8, 10, 12	6TON62SS	TBM6262	TBM8-750C4550	•	•	AC5X3	HS4-30	1.69 (42,9)	1.19 (30.2)	Yellow
	2/0	#1, 2	6TON62SS	TBM6262	TBM8-750C4550	•	•	AC5X3	HS4-30	1.69 (42,9)	1.19 (30.2)	
	1/0	1/0, 1	6TON62SS	TBM6262	TBM8-750C4550	•	•	AC5X3	HS4-30	1.69 (42,9)	1.19 (30.2)	

### Diagrams

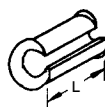

Fig. 1

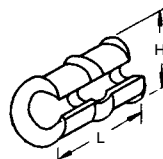

Fig. 2

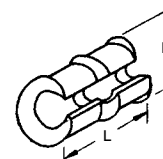

Fig. 3

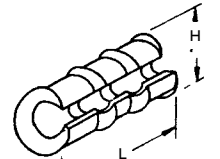

Fig. 4

\*\*\* When using #3 AWG on main and #12 AWG on branch with Smart Tools and dies, #12 AWG wire must be doubled (hair-pinned) and placed on branch for crimping.

Group 1 = TBM6H, TBM62PCR-LI, TBM62CR-LI, TBM6UNICR-LI.

Group 2 = TBM45S, TBM41E (require 2 compressions within each crimp area).

Group 3 = TBM4/4S, TBM5S, TBM6S, TBM8/8S, TBM6H (require 1 compression within each crimp area).

## C-Taps



### Certified to 600 V

- More economical than other taps and split bolts in terms of purchase, inventory, installation time, insulation and maintenance
- Color-coded for easy matching with proper die
- Barely larger than conductor insulation once installed

**Material** – High-conductivity wrought copper

**Finish** – Plain



### Large size

Cat. no.	Wire size (AWG or kcmil)		Dimensions in. (mm)			Installing die			No. of crimps	Colour code
	Main	Branch	C	D	E	Tool	Cat. no.	Die code		
54755	#1	#1	1.93 (49.0)	0.75 (19.1)	0.53 (13.5)	TBM14M	15512SS	76	1	Blue
	1/0	1/0-#2				TBM15I	15512SS*	76		
	2/0	2/0-#3				TBM12	TBM12D-4	76		
	3/0	1/0-#6				13100A	15512SS	76		
	4/0	#1-#8								
54760	2/0	2/0-#1	1.43 (36.3)	0.75 (19.1)	0.59 (15.0)	TBM14M	15506SS	87H	2	Brown
	3/0	3/0-#3				TBM15I	15506SS*	87H		
	4/0	4/0-#4				TBM12	TBM12D-3	87H		
	250	#1-#8				13100A	15506SS	87H		
54765	2/0	2/0-#1	1.68 (42.7)	1.00 (25.4)	0.64 (16.3)	TBM14M	15505SS	99H	2	Pink
	3/0	3/0-#2				TBM15I	15505SS*	99H		
	4/0	4/0-#4				TBM12	TBM12D-2	99H		
	250	3/0-#6				13100A	15505SS	99H		
	300	2/0-#8								
54770	4/0	4/0-2/0	1.68 (42.7)	1.00 (25.4)	0.68 (17.3)	TBM14M	15515SS	106H	2	Black
	250	250-#1				TBM15I	15515SS*	106H		
	300	4/0-#4				TBM12	TBM12D-2	106H		
	350	3/0-#6				13100A	15515SS	106H		
54775**	250	250	1.88 (47.8)	1.25 (31.8)	0.81 (20.6)	TBM14M	15504SS	115H	2	Yellow
	300	300-3/0				TBM15I	15504SS*	115H		
	350	350-1/0				TBM12	TBM12D-1	115H		
	400	300-#2				13100A	15504SS	115H		
	450	250-#4								
	500	250-#6								
54780	350	350-4/0	2.18 (55.4)	1.25 (31.8)	0.82 (20.08)	TBM15I	15603	125H	2	N/A
	400	400-2/0								
	450	450-#1								
	500	500-#2								
54785	750	4/0-#6	2.12 (53.8)	2.00 (50.8)	1.00 (25.4)	TBM15I	15603	125H	3	N/A
54790	750	750-4/0	2.68 (68.1)	2.00 (50.8)	1.31 (33.3)	TBM15I	15603	125H	3	N/A

### Diagrams

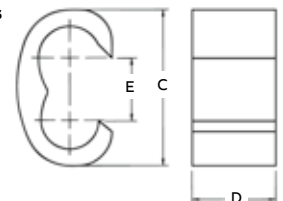

UL approved for direct burial.

For covers see the Color-Keyed compression connector system catalogue.

Taps can be supplied tin-plated. Add suffix "TP" to any cat. no. (i.e. 54725TP).

\* Cat. no. 15500TB adaptor required if using TBM15I and 155xx series dies.

\*\* #6 AWG branch must be doubled.

Tooling and die selector chart, see the Color-Keyed tools, dies and kits catalogue.

## Copper lugs

### Heavy-duty two-hole NEMA lugs



- Heavy-wall lugs for grounding and other critical applications
- Able to handle the most severe heavy-loading applications
- Ease cable insertion

#### Heavy-duty two-hole NEMA lugs

Meets IEEE 837 -2014 requirements

Cat. no.	Wire size (AWG or kcmil)	Installing dies*	Dimensions (in.)			
			B	L	P	W
HDL 2 N	#2	15508SS	1½	5¼	3	13/16
HDL 1 N	#1	15526SS	1½	5¼	3	13/16
HDL 1/0 N	1/0	15530SS	1½	5¼	3	13/16
HDL 2/0 N	2/0	15511SS	1¾	5½	3	15/16
HDL 3/0 N	3/0	15532SS	1 <sup>11</sup> / <sub>16</sub>	5 <sup>3</sup> / <sub>16</sub>	3	1
HDL 4/0 N	4/0	15514SS	1¾	5 <sup>5</sup> / <sub>8</sub>	3	1 <sup>1</sup> / <sub>8</sub>
HDL 250 N	250	15517SS	1¾	5 <sup>5</sup> / <sub>8</sub>	3	1 <sup>1</sup> / <sub>4</sub>
HDL 300 N	300	15506SS	2¼	5 <sup>13</sup> / <sub>16</sub>	3	1 <sup>3</sup> / <sub>8</sub>
HDL 350 N	350	15503SS	2 <sup>5</sup> / <sub>16</sub>	6 <sup>9</sup> / <sub>16</sub>	3	1 <sup>1</sup> / <sub>2</sub>
HDL 500 N	500	15609SS	2 <sup>5</sup> / <sub>8</sub>	6 <sup>3</sup> / <sub>8</sub>	3	1 <sup>3</sup> / <sub>4</sub>
HDL 750 N**	750	Consultez votre représentant ABB.	3 <sup>5</sup> / <sub>8</sub>	7 <sup>3</sup> / <sub>16</sub>	3	2 <sup>3</sup> / <sub>16</sub>
HDL 1000 N**	1,000	Consultez votre représentant ABB.	4 <sup>5</sup> / <sub>8</sub>	9 <sup>5</sup> / <sub>8</sub>	3 <sup>5</sup> / <sub>8</sub>	2 <sup>5</sup> / <sub>8</sub>

Diagram

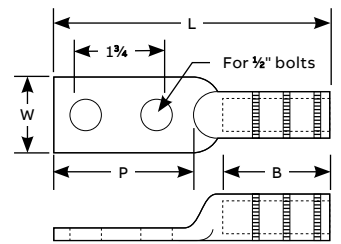

Note: For tin plating, add suffix "-TN" after the catalogue number.  
For oxide-inhibiting compound, contact your ABB representative.

\*These dies may be used with the TBM15CR-LI or TBM15I compression tools. Please note that the die adapter 15500-TB is required for use with these tools.

\*\* Do not meet IEEE 837-2014 requirements.

## Pigtail connectors



**Hex compression intimately bonds directly to copper-clad ground rod**

- Figure 8 connectors
- Conforms to IEEE 837 standard
- UL listed

When connecting cable to copper-clad ground rod for direct burial or in concrete, the connector shall be wrought copper with minimum conductivity of 99% I.A.C.S., such as ABB series GR12-306. Hex compression with die code embossing shall be used.



Cat. no.	Cable range (AWG)	Copper clad ground rod (in.)	Die code for TBM14M, TBM15, 13100A or TBM15I	No. of crimps	Die cat. no.
GR12-306	One cable: 3/0 to #6 Two cables: #2 to #6	1/2	87H	2	15506
GR58-406	One cable: 4/0 to #6 Two cables: #2 to #6	5/8	87H	2	15506
GR34-4010	One cable: 4/0 to 1/0	3/4	99H	2	15505



## Ground plates



Cat. no.	Fig.	Cable range (AWG or kcmil)	H in. (mm)	No. of crimps	Die code for 14- and 15-ton tools
GP2250-2	1	#2-250	3.63 (92.2)	1	15G86R
GP2250-4	2	#2-250	4.22 (107.2)	1	15G86R
GP250500-2	1	250-500	3.63 (92.2)	2	15G126R
GP250500-4	2	250-500	4.22 (107.2)	2	15G126R

### Diagrams

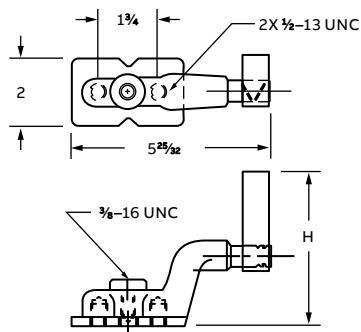

Figure 1

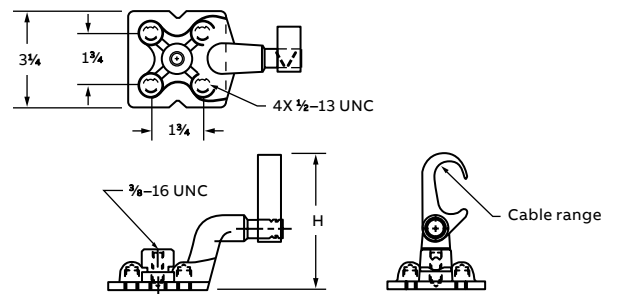

Figure 2

## Grounding studs



### Type TBGS structural grounding studs

Knurling ensures excellent mechanical pull-out and electrical continuity.

- Easily welded to steel structures with minimal construction welding equipment
- Connect to grounding conductors with appropriate ABB grounding connectors
- Knurled portion of stud resists pull-out and provides electrical continuity to ensure the integrity of the grounding circuit
- Constructed of high-strength steel and coated with corrosion-resistant copper cyanide

Cat. no.	Rod size (in.)
TBGS-14	0.25
TBGS-38	0.38
TBGS-58	0.63
TBGS-34	0.75

### Diagrams

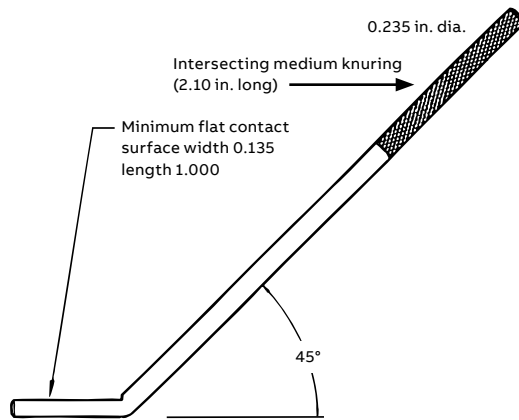

TBGS-14

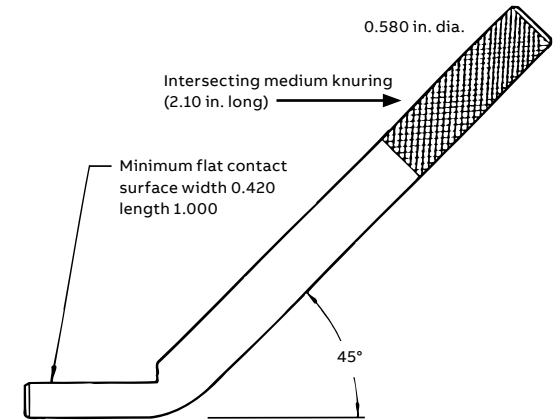

TBGS-58

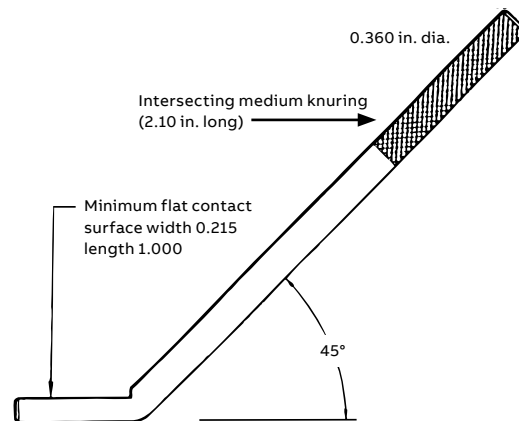

TBGS-38

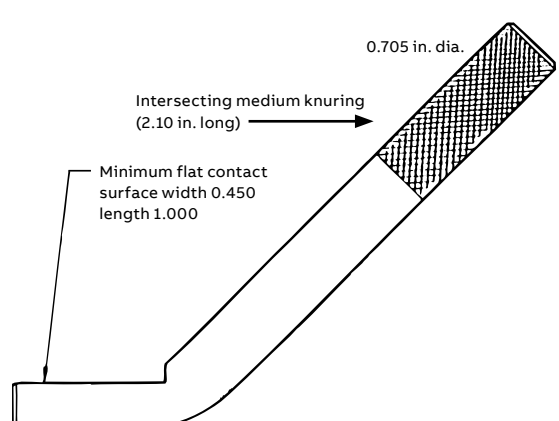

TBGS-34

## Bus bar connectors

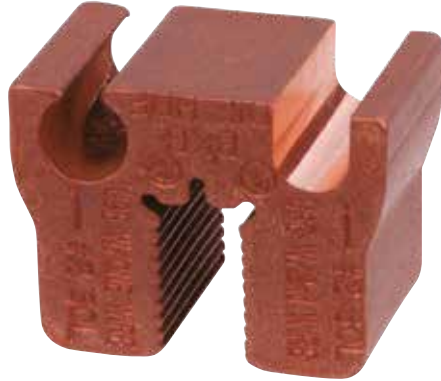

### Cuts installation time in half – with results superior to conventional connectors

- Unique
- Fast and easy installation
- Superior low-resistance, high-conductivity connections
- Install with conventional compression tools
- Produce a permanent connection with any combination of copper from #6 to #2 AWG solid or stranded conductors, to ¼ in. copper bus bar
- Made from pure wrought copper and prefilled with oxide inhibitor
- CSA certified and UL listed
- Installed with die HDF

EZGround bus bar connectors install in less than 2 minutes with one easy crimp. The connector attaches directly to the bus, saving the labor-intensive process of drilling and tapping. The unique jaw interface of the EZGround bus bar connector grips the copper bus, resulting in a low-resistance, high-conductivity connection. The EZGround bus bar connectors can be used in OEM applications or telecom applications – cellular, PCS and others. They provide a continuous ground to the copper bus bar, making them ideal for tower applications. The design enables installation in virtually any position, horizontal or vertical, and is suitable for inside and outside plant use. Installation can be completed using tool TBM14, TBM14MC or TBM14CR-LI.

### Busbar connectors



Cat. no.	Ground bus bar (in.)	Conductor range (AWG)	Tools	Die	Std. pkg. qty.
GBBC22	¼	#2-#2	TBM14M, TBM14MC, TBM14CR-LI	HDF	1
GBBC26	¼	#6-#2	TBM14M, TBM14MC, TBM14CR-LI	HDF	1

### Diagrams

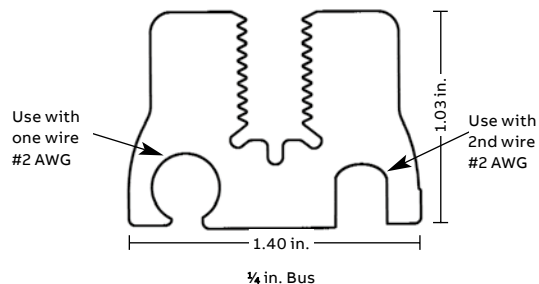

Use this side of the connector when using only one wire.

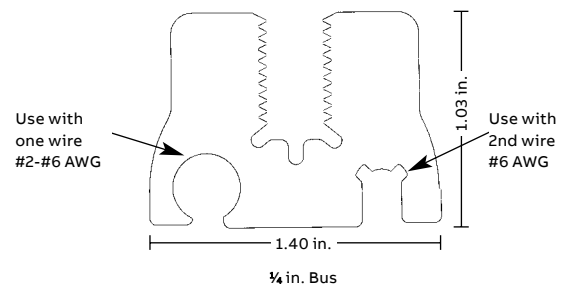

Use this side of the connector only when using two wires.