PMAFIX Pro

Introduction

Next generation cable protection. The extremely successful and technically proven PMAFIX System has been developed further to create the PMAFIX Pro product range.

The new generation fittings are the product of experience gained over many years in the most varied application areas. The PMAFIX Pro has two components, an outer body and an inner sealing element. The sealing element functions both as a seal and as a locking mechanism providing all ingress protection grades up to IP68 and IP69 even in applications where there is long term continuous movement. PMAFIX Pro is manufactured by using multiple component injection moulding process.

Key features

- Meets all ingress protection categories up to and including IP68 and IP69 also when the conduit connection is continually in motion
- Manufactured with newest 2-component injection moulding technology
- Fulfills highest international quality and standard requirements
- Intelligent safety locking mechanism
- Allows simple “push-in” installation of conduit
- Due to the integrated conduit supports conduit remains centralised with little deformation even when bent sharply directly at the fitting





PMAFIX Pro

General technical details

—
01 patent
—
02 Up to 100 bar

Material

- Fittings made from specially modified polyamide 6
- Threads made from nickel-plated brass or polyamide 6
- Sealings made from cross linked polyester elastomer
- Self-extinguishing
- Free from halogens, REACH + RoHS compliant
- Temperature range: -50°C to +105°C, short-term to +160°C

Characteristics

- Highest assembly reliability – the fitting only locks when the sealing element is fully inserted
- Highest operational safety assured through visual and acoustic correct assembly controls
- Excellent resistance to ultra violet rays and weathering
- Highest impact resistance through fully closed design
- Highest conduit pull out strength
- Vibration-proof connection to PMA conduit
- Fits conduit profiles – fine (T) and coarse (G)
- To avoid accidental opening, disassembling only possible with a screwdriver



—
01



—
02

IP68 + IP69

Static + dynamic

- Highest sealing through fully closed system also in highest dynamic applications
- Extra long ribbed sealing areas (cross linked material)
- 360° locking and sealing element shields against high pressure water jets (up to 100 bar)
- Content of delivery: Locking and sealing element and thread seal for male threads (O-Ring and/or flat gasket)

electrosuisse»

BOMBARDIER
Transportation



TRENITALIA



EN

ALSTOM



SIEMENS



PMAFIX Pro

Part number codes

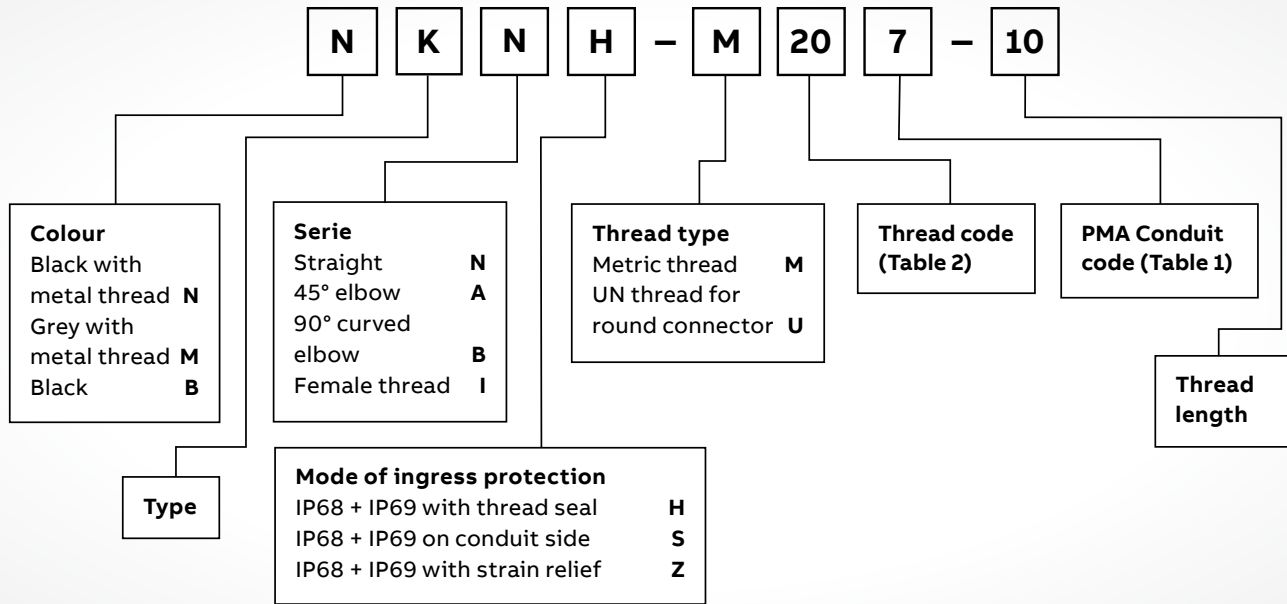

Connector series IP68 + IP69

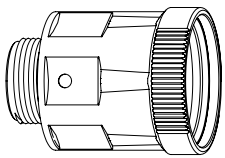

01

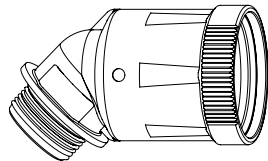

02

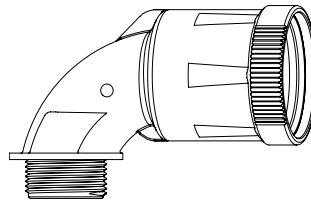

03

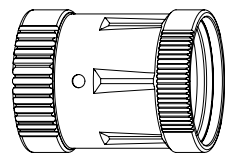

04

01 Straight (N)

02 45° elbow (A)

03 90° curved elbow (B)

04 Female thread (I)

PMAFIX Pro

Size codes, installation

Table 1: Conduit codes

Nominal width	Metric size	PMA code
10	12	0
12	16	2
17	20	7
23	25	3
29	32	9
36	40	6
48	50	8

Table 2: Thread codes

Thread Metric	PMA code
M12x1.5	M12
M16x1.5	M16
M20x1.5	M20
M25x1.5	M25
M32x1.5	M32
M40x1.5	M40
M50x1.5	M50
M63x1.5	M63

Thread UN	PMA code
7/8-20 UNEF	U21
1-20 UNEF	U24
1 1/16-18 UNEF	U29
1 7/16-18 UNEF	U35
1 3/4-18 UNS	U43
2-18 UNS	U50
2 1/4-16 UN	U56

Additional code for female thread connectors

Type	PMA code
With O-ring groove (MIL C 5015)	G

Installation IP68 + IP69

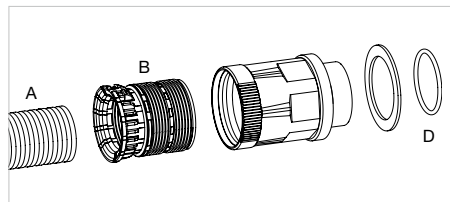

01

A = Corrugated conduit
 B = Sealing and locking element
 C = Fitting body
 D = Thread seal (O-ring or glat gasket *)

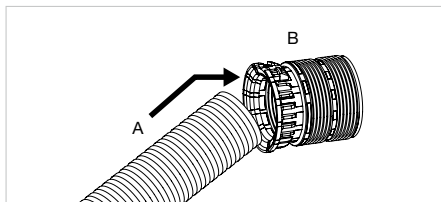

02

Place corrugated conduit (A) at a slight angle against the sealing element (B), then push right into the end.

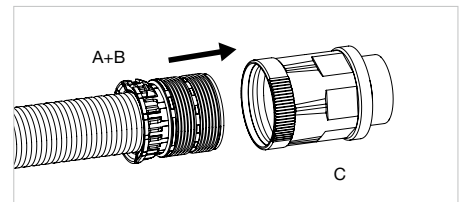

03

Push the conduit and sealing element (A+B) together into the outer body of the fitting (C). Water or a lubricating agent can help facilitate the push-in process.

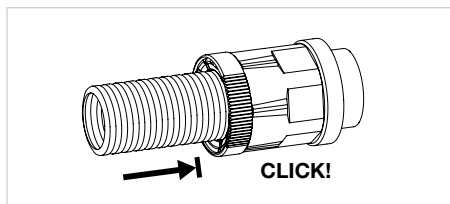

04

The locking mechanism engages when the sealing element is pushed in fully.

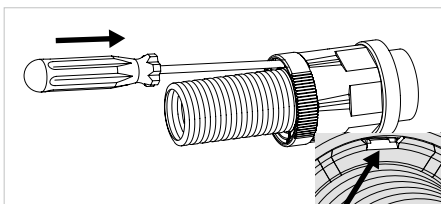

05

To disengage the locking mechanism introduce a size 1 screwdriver parallel to the conduit into the opening shown in the detail drawing.

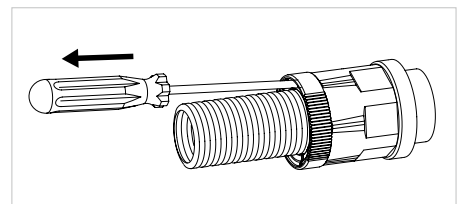

06

Pull the conduit and screwdriver out of the fitting together keeping the screwdriver parallel to the conduit.

PMAFIX Pro

Connectors metric, metal thread

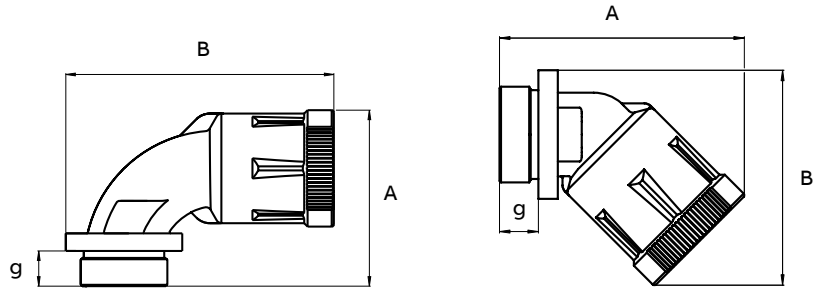

g = Thread length
A x B = External dimensions

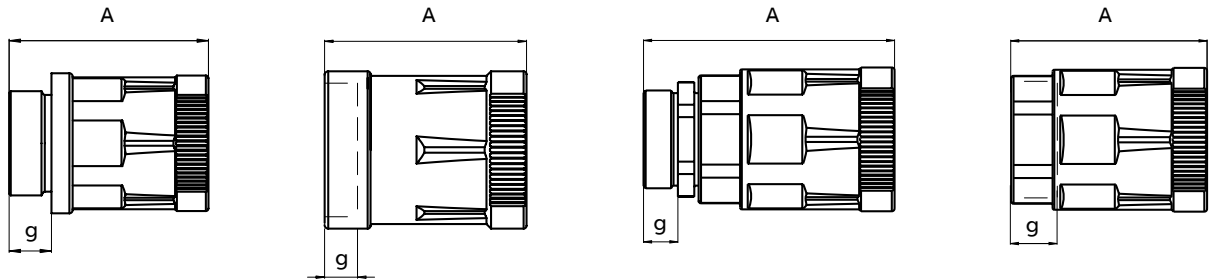

g = Thread length
A = Overall length

Type KNH - Connector straight, metric metal thread

	Order no. black IP68 + IP69	Order no. grey IP68 + IP69	Thread metric	Fits to conduit size		Thread length (mm)	Overall length (mm)
				NW	Metric		
	NKNH-M120-10	MKNH-M120-10	M12 x 1.5	10	12	10.0	45.0
	NKNH-M160-10	MKNH-M160-10	M16 x 1.5	10	12	10.0	45.0
	NKNH-M162-10	MKNH-M162-10	M16 x 1.5	12	16	10.0	50.5
	NKNH-M202-10	MKNH-M202-10	M20 x 1.5	12	16	10.0	50.5
	NKNH-M207-10	MKNH-M207-10	M20 x 1.5	17	20	10.0	56.0
	NKNH-M257-11	MKNH-M257-11	M25 x 1.5	17	20	11.0	57.0
	NKNH-M253-11	MKNH-M253-11	M25 x 1.5	23	25	11.0	59.5
	NKNH-M323-13	MKNH-M323-13	M32 x 1.5	23	25	13.0	61.5
	NKNH-M329-13	MKNH-M329-13	M32 x 1.5	29	32	13.0	67.0
	NKNH-M409-13	MKNH-M409-13	M40 x 1.5	29	32	13.0	68.5
	NKNH-M406-13	MKNH-M406-13	M40 x 1.5	36	40	13.0	74.0
	NKNH-M506-14	MKNH-M506-14	M50 x 1.5	36	40	14.0	75.0
	NKNH-M508-14	MKNH-M508-14	M50 x 1.5	48	50	14.0	81.0
	NKNH-M638-14	MKNH-M638-14	M63 x 1.5	48	50	14.0	81.0

Approvals





For applications in railway vehicles and heavy machine construction
High thread and system connection strength

Connectors metric, metal thread

Type KNZ

Type KNZ - Connector straight with strain relief, metric metal thread



	Order no. IP68 + IP69 Compl., black	Order no. fitting*	Order no. insert	Thread metric	Fits to conduit size		Terminal range (mm)	Thread length (mm)	Overall length (mm)
					NW	Metric			
KNZ, patent	NKNZ-M120/P1	NKNZ-M120R/P	EK 150/p7	M12 x 1.5	10	12	4.0–6.5	5.0	53.5
	NKNZ-M120/P2		EK 150/p8	M12 x 1.5	10	12	5.0–8.0	5.0	53.5
	NKNZ-M120/P3		EK 150/p9	M12 x 1.5	10	12	6.5–9.5	5.0	53.5
	NKNZ-M160/P1	NKNZ-M160R/P	E 150/p7	M16 x 1.5	10	12	4.0–6.5	6.0	54.5
	NKNZ-M160/P2		E 150/p8	M16 x 1.5	10	12	5.0–8.0	6.0	54.5
	NKNZ-M160/P3		E 150/p9	M16 x 1.5	10	12	6.5–9.5	6.0	54.5
	NKNZ-M202/P1	NKNZ-M202R/P	E 152/p7	M20 x 1.5	12	16	4.0–6.5	6.5	60.5
	NKNZ-M202/P3		E 152/p9	M20 x 1.5	12	16	6.5–9.5	6.5	60.5
	NKNZ-M202/P4		E 152/p11	M20 x 1.5	12	16	7.0–10.5	6.5	60.5
	NKNZ-M207/P3	NKNZ-M207R/P	E 152/p9	M20 x 1.5	17	20	6.5–9.5	6.5	66.5
	NKNZ-M207/P4		E 152/p11	M20 x 1.5	17	20	7.0–10.5	6.5	66.5
	NKNZ-M207/P5		E 152/p13	M20 x 1.5	17	20	9.0–13.0	6.5	66.5
	NKNZ-M257/P4	NKNZ-M257R/P	E 153/p11	M25 x 1.5	17	20	7.0–10.5	7.5	67.5
	NKNZ-M257/P5		E 153/p13	M25 x 1.5	17	20	9.0–13.0	7.5	67.5
	NKNZ-M257/P6		E 153/p16	M25 x 1.5	17	20	11.5–15.5	7.5	67.5
	NKNZ-M253/P5	NKNZ-M253R/P	EK 154/p13	M25 x 1.5	23	25	9.0–13.0	7.5	75.0
	NKNZ-M253/P6	NKNZ-M253R1/P	EK 154/p16	M25 x 1.5	23	25	11.5–15.5	7.5	75.0
	NKNZ-M323/P2	NKNZ-M323R/P	E 154/p13	M32 x 1.5	23	25	9.0–13.0	8.0	76.0
	NKNZ-M323/P4		E 154/p18	M32 x 1.5	23	25	14.0–18.0	8.0	76.0
	NKNZ-M323/P5	NKNZ-M323R1/P	E 154/p20	M32 x 1.5	23	25	17.0–20.5	8.0	76.0
	NKNZ-M329/P2	NKNZ-M329R/P	EK 155/p18	M32 x 1.5	29	32	14.0–18.0	8.0	83.0
	NKNZ-M329/P3		EK 155/p20	M32 x 1.5	29	32	17.0–20.5	8.0	83.0
	NKNZ-M329/P4		EK 155/p25	M32 x 1.5	29	32	20.0–25.0	8.0	83.0
	NKNZ-M409/P1	NKNZ-M409R/P	E 155/p16	M40 x 1.5	29	32	11.5–15.5	8.0	83.0
	NKNZ-M409/P2		E 155/p18	M40 x 1.5	29	32	14.0–18.0	8.0	83.0
	NKNZ-M409/P3		E 155/p20	M40 x 1.5	29	32	17.0–20.5	8.0	83.0
	NKNZ-M409/P4		E 155/p25	M40 x 1.5	29	32	20.0–25.0	8.0	83.0
	NKNZ-M409/P5		E 155/p28	M40 x 1.5	29	32	24.0–28.0	8.0	83.0
	NKNZ-M406/P1	NKNZ-M406R/P	E 156/p25HF	M40 x 1.5	36	40	20.0–25.0	9.0	87.5
	NKNZ-M406/P2		EK 156/p28	M40 x 1.5	36	40	24.0–28.0	9.0	87.5
	NKNZ-M506/P1	NKNZ-M506R/P	E 156/p32	M50 x 1.5	36	40	27.0–32.0	10.0	90.0
	NKNZ-M506/P3		E 156/p36	M50 x 1.5	36	40	32.0–36.0	10.0	90.0
	NKNZ-M508/P2	NKNZ-M508R/P	E 157/p36HF	M50 x 1.5	48	50	32.0–36.0	10.0	100.0
	NKNZ-M508/P3		E 157/p40HF	M50 x 1.5	48	50	36.0–40.0	10.0	100.0
	NKNZ-M638/P1	NKNZ-M638R/P	E 158/pm1x35	M63 x 1.5	48	50	32.0–35.0	10.0	100.0
	NKNZ-M638/P2		E 158/p44	M63 x 1.5	48	50	39.0–44.0	10.0	100.0

Approvals



* without insert

For applications in railway vehicles and heavy machine construction

For the separation of damp and dry areas

Sealing inserts are made from TPE-V

With integrated strain relief and optimal ingress protection at the cable (up to IP68/10 bar)

High thread and system connection strength

Temperature range sealing insert Pflitsch: -40°C to +135°C

Note: For several conductors multiple sealing inserts MDE are available. R/P version of fitting has to be used in combination with multiple sealing inserts

Connectors metric, metal thread

Type KNZ

Type KNZ - Connector straight with strain relief, metric long metal thread



	Order no. IP68 + IP69 Compl., black	Order no. fitting*	Order no. insert	Thread metric	Fits to conduit size		Terminal range (mm)	Thread length (mm)	Overall length (mm)
					NW	Metric			
	NKNZ-M160/P1-L	NKNZ-M160R/P-L	E 150/p7	M16 x 1.5	10	16	4.0–6.5	15.0	63.5
	NKNZ-M160/P2-L		E 150/p8	M16 x 1.5	10	16	5.0–8.0	15.0	63.5
	NKNZ-M160/P3-L		E 150/p9	M16 x 1.5	10	16	6.5–9.5	15.0	63.5
	NKNZ-M202/P1-L	NKNZ-M202R/P-L	E 152/p7	M20 x 1.5	12	20	4.0–6.5	15.0	69.0
	NKNZ-M202/P3-L		E 152/p9	M20 x 1.5	12	20	6.5–9.5	15.0	69.0
	NKNZ-M202/P4-L		E 152/p11	M20 x 1.5	12	20	7.0–10.5	15.0	69.0
	NKNZ-M207/P3-L	NKNZ-M207R/P-L	E 152/p9	M20 x 1.5	17	20	6.5–9.5	15.0	75.0
	NKNZ-M207/P4-L		E 152/p11	M20 x 1.5	17	20	7.0–10.5	15.0	75.0
	NKNZ-M207/P5-L		E 152/p13	M20 x 1.5	17	20	9.0–13.0	15.0	75.0
	NKNZ-M257/P5-L	NKNZ-M257R/P-L	E 153/p13	M25 x 1.5	17	25	9.0–13.0	15.0	75.0
	NKNZ-M257/P6-L		E 153/p16	M25 x 1.5	17	25	11.5–15.5	15.0	75.0
	NKNZ-M323/P2-L	NKNZ-M323R/P-L	E 154/p13	M32 x 1.5	23	32	9.0–13.0	15.0	83.0
	NKNZ-M323/P4-L		E 154/p18	M32 x 1.5	23	32	14.0–18.0	15.0	83.0
	NKNZ-M323/P5-L	NKNZ-M323R1/P-L	E 154/p20	M32 x 1.5	23	32	17.0–20.5	15.0	83.0
	NKNZ-M329/P2-L	NKNZ-M329R/P-L	EK 155/p18	M32 x 1.5	29	32	14.0–18.0	15.0	90.0
	NKNZ-M329/P3-L		EK 155/p20	M32 x 1.5	29	40	17.0–20.5	15.0	90.0
	NKNZ-M409/P3-L	NKNZ-M409R/P-L	E 155/p20	M40 x 1.5	29	40	17.0–20.5	15.0	90.0
	NKNZ-M409/P4-L		E 155/p25	M40 x 1.5	29	40	20.0–25.0	15.0	90.0
	NKNZ-M409/P5-L		E 155/p28	M40 x 1.5	29	50	24.0–28.0	15.0	90.0
	NKNZ-M506/P1-L	NKNZ-M506R/P-L	E 156/p32	M50 x 1.5	36	50	27.0–32.0	15.0	95.0
NKNZ-M506/P3-L		E 156/p36	M50 x 1.5	36	50	32.0–36.0	15.0	95.0	
NKNZ-M508/P2-L	NKNZ-M508R/P-L	E 157/p36HF	M50 x 1.5	48	50	32.0–36.0	15.0	105.0	
NKNZ-M508/P3-L		E 157/p40HF	M50 x 1.5	48	50	36.0–40.0	15.0	105.0	
NKNZ-M638/P1-L	NKNZ-M638R/P-L	E 158/pm1x35	M63 x 1.5	48	63	32.0–35.0	15.0	105.0	
NKNZ-M638/P2-L		E 158/p44	M63 x 1.5	48	63	39.0–44.0	15.0	105.0	

* without insert

For applications in railway vehicles and heavy machine construction

For the separation of damp and dry areas

Sealing inserts are made from TPE-V

With integrated strain relief and optimal ingress protection at the cable (up to IP68/10 bar)

High thread and system connection strength

Temperature range sealing insert Pflitsch: -40°C to +135°C

Note: For several conductors multiple sealing inserts MDE are available. R/P version of fitting has to be used in combination with multiple sealing inserts

Approvals



Connectors metric, metal thread

Type KAH & KBH

Type KAH - Connector 45° elbow, metric metal thread

	Order no. black IP68 + IP69	Order no. grey IP68 + IP69	Thread metric	Fits to conduit size		Thread length (mm)	External dimensions (mm)
				NW	Metric		
	NKAH-M120-10	MKAH-M120-10	M12 x 1.5	10	12	10.0	55.5 x 43.0
	NKAH-M160-10	MKAH-M160-10	M16 x 1.5	10	12	10.0	55.5 x 45.0
	NKAH-M162-10	MKAH-M162-10	M16 x 1.5	12	16	10.0	62.5 x 50.0
	NKAH-M202-10	MKAH-M202-10	M20 x 1.5	12	16	10.0	62.5 x 52.0
	NKAH-M207-10	MKAH-M207-10	M20 x 1.5	17	20	10.0	71.0 x 59.5
	NKAH-M257-11	MKAH-M257-11	M25 x 1.5	17	20	11.0	72.0 x 62.5
	NKAH-M253-11	MKAH-M253-11	M25 x 1.5	23	25	11.0	80.0 x 68.0
	NKAH-M323-13	MKAH-M323-13	M32 x 1.5	23	25	13.0	82.0 x 72.0
	NKAH-M329-13	MKAH-M329-13	M32 x 1.5	29	32	13.0	93.0 x 79.5
	NKAH-M409-13	MKAH-M409-13	M40 x 1.5	29	32	13.0	94.5 x 85.5
	NKAH-M406-13	MKAH-M406-13	M40 x 1.5	36	40	13.0	105.5 x 93.5
	NKAH-M506-14	MKAH-M506-14	M50 x 1.5	36	40	14.0	106.5 x 98.5
	NKAH-M508-14	MKAH-M508-14	M50 x 1.5	48	50	14.0	120.0 x 111.0
	NKAH-M638-14	MKAH-M638-14	M63 x 1.5	48	50	14.0	120.0 x 114.0

Approvals



For applications in railway vehicles and heavy machine construction
High thread and system connection strength

Type KBH - Connector 90° curved elbow, metric metal thread

	Order no. black IP68 + IP69	Order no. grey IP68 + IP69	Thread metric	Fits to conduit size		Thread length (mm)	External dimensions (mm)
				NW	Metric		
	NKBH-M120-10	MKBH-M120-10	M12 x 1.5	10	12	10.0	44.0 x 62.5
	NKBH-M160-10	MKBH-M160-10	M16 x 1.5	10	12	10.0	44.0 x 64.5
	NKBH-M162-10	MKBH-M162-10	M16 x 1.5	12	16	10.0	47.5 x 72.0
	NKBH-M202-10	MKBH-M202-10	M20 x 1.5	12	16	10.0	47.5 x 74.0
	NKBH-M207-10	MKBH-M207-10	M20 x 1.5	17	20	10.0	53.0 x 81.0
	NKBH-M257-11	MKBH-M257-11	M25 x 1.5	17	20	11.0	54.0 x 84.0
	NKBH-M253-11	MKBH-M253-11	M25 x 1.5	23	25	11.0	63.0 x 92.0
	NKBH-M323-13	MKBH-M323-13	M32 x 1.5	23	25	13.0	65.0 x 96.0
	NKBH-M329-13	MKBH-M329-13	M32 x 1.5	29	32	13.0	75.0 x 108.0
	NKBH-M409-13	MKBH-M409-13	M40 x 1.5	29	32	13.0	76.5 x 114.0
	NKBH-M406-13	MKBH-M406-13	M40 x 1.5	36	40	13.0	87.5 x 126.0
	NKBH-M506-14	MKBH-M506-14	M50 x 1.5	36	40	14.0	88.5 x 131.0
	NKBH-M508-14	MKBH-M508-14	M50 x 1.5	48	50	14.0	101.0 x 145.5
	NKBH-M638-14	MKBH-M638-14	M63 x 1.5	48	50	14.0	101.0 x 148.5

Approvals



For applications in railway vehicles and heavy machine construction
High thread and system connection strength
Smooth elbow allows easy threading of wires and cables

Connectors, female polyamide UNEF thread

Type KIHG

Type KIHG - Connector straight, UN female thread for MIL-C5015

	Order no. black IP68 + IP69	Thread UN	Shell size MIL	Fits to conduit size		Thread length (mm)	Overall length (mm)
				NW	Metric		
KIHG, patent 	BKIHG-U212	7/8"-20 UNEF	16	12	16	9.0	47.0
	BKIHG-U217	7/8"-20 UNEF	16	17	20	9.0	52.5
	BKIHG-U242	1"-20 UNEF	18	12	16	9.0	47.0
	BKIHG-U247	1"-20 UNEF	18	17	20	9.0	52.5
	BKIHG-U243	1"-20 UNEF	18	23	23	9.0	55.5
	BKIHG-U292	1 3/16"-18 UNEF	20	12	16	9.0	50.5
	BKIHG-U297	1 3/16"-18 UNEF	20	17	20	9.0	52.5
	BKIHG-U293	1 3/16"-18 UNEF	20	23	25	9.0	55.5
	BKIHG-U299	1 3/16"-18 UNEF	20	29	32	9.0	61.0
	BKIHG-U357	1 7/16"-18 UNEF	24	17	20	9.0	58.0
	BKIHG-U353	1 7/16"-18 UNEF	24	23	25	9.0	55.5
	BKIHG-U359	1 7/16"-18 UNEF	24	29	32	9.0	61.0
	BKIHG-U433	1 3/4"-18 UNS	32	23	25	10.0	62.5
	BKIHG-U439	1 3/4"-18 UNS	32	29	32	10.0	62.0
	BKIHG-U503	2"-18 UNS	36	23	25	10.0	67.0
	BKIHG-U509	2"-18 UNS	36	29	32	10.0	67.5
	BKIHG-U506	2"-18 UNS	36	36	40	10.0	67.0
	BKIHG-U508	2"-18 UNS	36	48	50	10.0	73.5
BKIHG-U566	2 3/4"-16 UN	40	36	40	10.0	72.0	
BKIHG-U568	2 3/4"-16 UN	40	48	50	10.0	73.5	

Approvals



For applications in railway vehicles and heavy machine construction
Suitable for MIL connector, series C5015

Connectors metric, female metal thread (sealing elements)

Type KIS & KNH2

Type KIS - Connector straight, metric metal female thread

	Order no. black IP68 + IP69	Thread metric	Fits to conduit size		Thread length (mm)	Overall length (mm)
			NW	Metric		
	NKIS-M162	M16 x 1.5	12	16	9.0	49.0
	NKIS-M207	M20 x 1.5	17	20	10.5	56.0
	NKIS-M253	M25 x 1.5	23	25	10.5	58.5
	NKIS-M329	M32 x 1.5	29	32	11.0	65.5
	NKIS-M406	M40 x 1.5	36	40	13.5	72.0
	NKIS-M508	M50 x 1.5	48	50	15.0	83.0
	NKIS-M638	M63 x 1.5	48	50	17.5	84.0

Approvals



For applications in railway vehicles and heavy machine construction
High thread and system connection strength
No seal on female thread side

Type KNH2 - PMAFIX Pro sealing and locking element

	Order no.	Fits to conduit size		Outside Ø (mm)	Overall length (mm)
		NW	Metric		
	KNH2-NW10	10	12	22.0	28.0
	KNH2-NW12	12	16	25.5	33.5
	KNH2-NW17	17	20	31.5	38.5
	KNH2-NW23	23	25	38.5	41.0
	KNH2-NW29	29	32	46.5	46.5
	KNH2-NW36	36	40	55.5	50.5
	KNH2-NW48	48	50	68.0	56.5

Connectors nylon straight fitting

Type JKNH

Type JKNH - Connector two-piece, straight, IP69, metric thread

	Order no. black	Thread size metric	Fits to conduit size NW	Dimensions					Weight kg/100 pcs	Packing unit/pcs
				g (mm)	Ø ID (mm)	Ø D (mm)	L max. (mm)	sw (mm)		
	JKNH-M162	M16 x 1.5	12	11.0	11.0	28.5	47.5	25	0.8	10
	JKNH-M202	M20 x 1.5	12	12.5	11.0	28.5	47.5	25	0.9	10
	JKNH-M207	M20 x 1.5	17	14.5	11.0	35.0	53.5	32	1.4	10
	JKNH-M257	M25 x 1.5	17	16.5	12.0	35.0	54.5	32	1.5	10
	JKNH-M253	M25 x 1.5	23	19.0	12.0	42.0	57.0	38	1.7	10
	JKNH-M323	M32 x 1.5	23	23.0	15.0	43.0	60.5	38	2.0	10
	JKNH-M329	M32 x 1.5	29	26.0	15.0	51.5	65.5	46	3.2	10
	JKNH-M409	M40 x 1.5	29	29.0	19.0	51.5	69.5	46	3.7	10
	JKNH-M406	M40x1.5	36	32.0	19.0	65.0	75.0	60	5.9	10
	JKNH-M506	M50 x 1.5	36	37.5	19.0	65.0	75.0	60	6.2	10
	JKNH-M508	M50 x 1.5	48	42.0	19.0	75.0	81.0	70	7.5	10
	JKNH-M638	M63 x 1.5	48	48.5	19.0	75.0	81.0	70	7.8	10

Approvals



Very high impact resistance - easy push-in assembly
Corrosion-free
Excellent conduit pull-out strength
IP69 system protection for indoor splash zone areas